

WEST SUSSEX COUNTY COUNCIL
((ADUR DISTRICT) (PARKING PLACES & TRAFFIC REGULATION)
(CONSOLIDATION) ORDER 2009)
(LANCING:CRABTREE LANE AND ADJOINING ROADS AMENDMENT) ORDER 2014

LANCING: LOCATION OF WAITING RESTRICTIONS



KEY:

OS TILE GRID

PARKING TILE GRID

LOCATION OF WAITING RESTRICTIONS

PARISH BOUNDARY

ROAD NETWORK



West Sussex County Council
Communities & Infrastructure
The Grange
Tower Street
Chichester
West Sussex
PO19 1RH

WEST SUSSEX COUNTY COUNCIL ((ADUR DISTRICT)
(PARKING PLACES AND TRAFFIC REGULATION)
(CONSOLIDATION) ORDER 2010)
(LANCING: CRABTREE LANE AND ADJOINING ROADS AMENDMENT)
ORDER 2014
LOCATION OF WAITING RESTRICTIONS



Reproduced from or based upon 2010 Ordnance Survey mapping with permission of the Controller of HMSO
(c) Crown Copyright reserved. Unauthorised reproduction infringes Crown copyright and may lead to
prosecution or civil proceedings West Sussex County Council Licence No. 100018485

SCALE: 1:20,000
DATE: 30/05/2014

Adur District - Key for Waiting Restrictions

All areas over which the provision of the orders apply are defined by the shaded areas as shown on the following plans plus a contiguous area not indicated on the plans of verge and/or footway between the carriageway edge and the highway boundary. The plans in this schedule are based upon grid references of the Ordnance Survey National Grid defined by the OSGB 36 triangulation.

Prohibition of waiting at any time

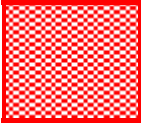
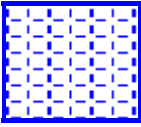
101		check	No waiting at any time
107		pat020	No waiting 8.00am-6.00pm Mon–Sat

Free Limited Waiting

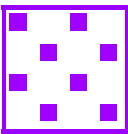
716		shd62	Waiting limited to 1hr No return within 1hr 8.00am-6.00pm Mon–Sat
-----	---	-------	--

WEST SUSSEX COUNTY COUNCIL
((ADUR DISTRICT) (PARKING PLACES & TRAFFIC REGULATION)
(CONSOLIDATION) ORDER 2009)

(LANSING: CRABTREE LANE AND ADJOINING ROADS AMENDMENT)
ORDER 2014

West Sussex County Council in exercise of their powers under Sections 1 (1) 2 (1) and (2), 4 (2), 45, 46, 49 and 53 and Part IV of Schedule 9 of the Road Traffic Regulation Act 1984 ("the Act") as amended and of all other enabling powers and after consultation with the Chief Officer of Police in accordance with Part III of Schedule 9 to the Act hereby make the following Order:-

1. This Order shall come into operation on the Thirtieth day of May 2014 and may be cited as "West Sussex County Council ((Adur District) (Parking Places & Traffic Regulation) (Consolidation) Order 2009) (Lancing: Vrabtree Lane and Adjoining Roads Amendment) Order 2014".
2. The "West Sussex County Council (Adur District) (Parking Places & Traffic Regulation) (Consolidation) Order 2009" is hereby amended by the replacement of the plan specified in the First Schedule to this Order, with the plan specified in the Second Schedule, attached hereto.

FIRST SCHEDULE
Plan to be Replaced

TQ1804NWN (Issue Number 1)

SECOND SCHEDULE
Replacement Plan

TQ1804NWN (Issue Number 2)

THE Common Seal of THE)
 WEST SUSSEX COUNTY COUNCIL)
 was hereto affixed the *TWENTY*)
NINTH)
 day of *MAY* 2014)
)
)
M. Kinsell)
 Authorised Signatory)
 ADR-1002-MM)



04/08 DELEGATED AUTHORITY

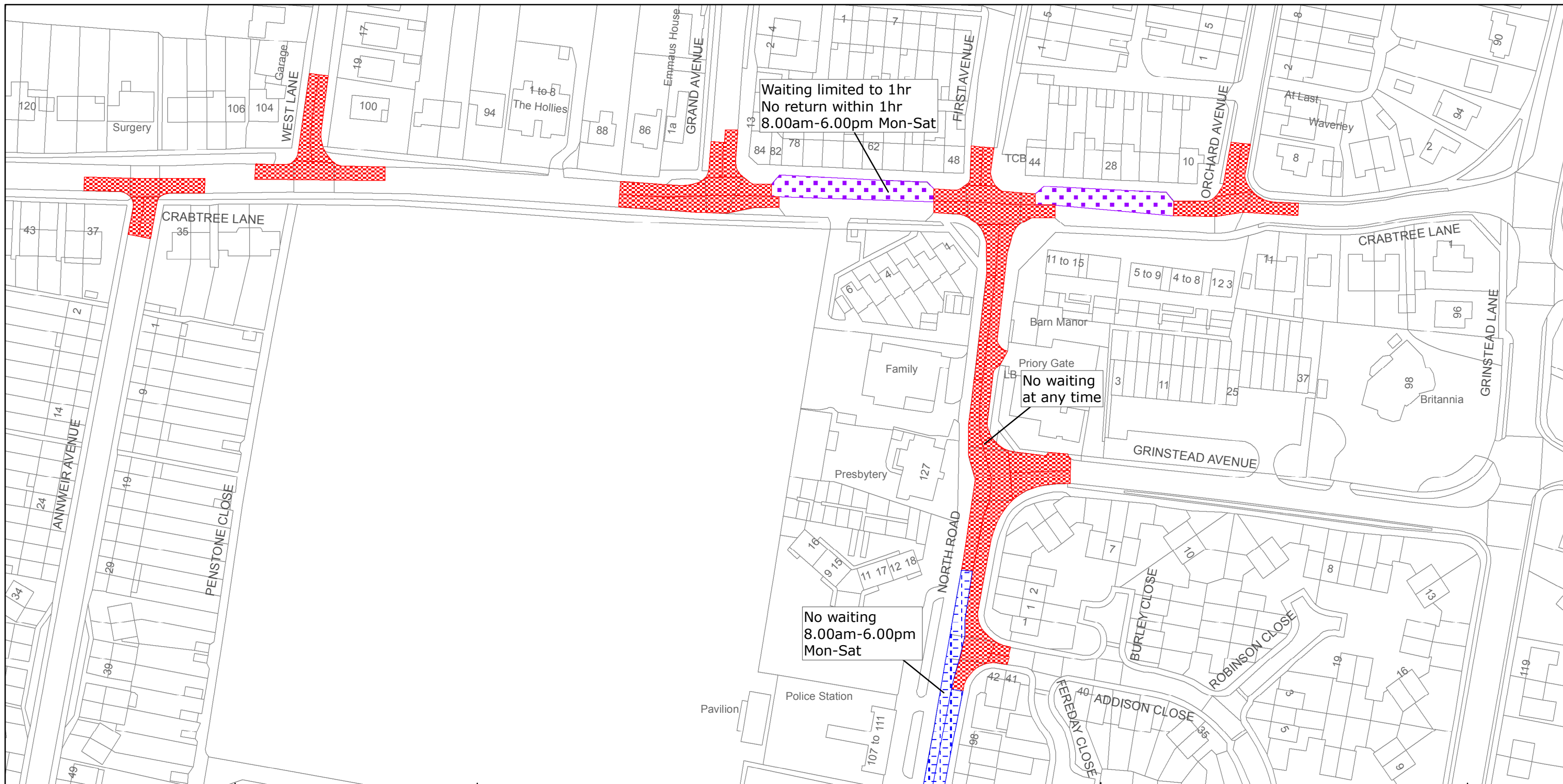

West Sussex County Council
Highways & Transport
The Grange
Tower Street
Chichester
West Sussex
PO19 1RH

ADUR DISTRICT: LANCING
WAITING RESTRICTIONS

Reproduced from or based upon 2010 Ordnance Survey mapping with permission of the Controller of HMSO (c) Crown Copyright reserved.
Unauthorised reproduction infringes Crown copyright and may lead to prosecution or civil proceedings West Sussex County Council Licence No. 100018485

TILE REF NO:
TQ1804NWN

SHEET ISSUE NO 2
SHEET ACTIVE FROM - 30/05/2014



SCALE:
1:1250
at A3 size